



Catalog 860-10

## Self-Contained Air Conditioning Systems

Type SWP  
Vintage H  
R-410A Refrigerant  
23 to 130 Tons

Model #: SWP099HSH27DBEBEEEEEEYYRS

Year: 2020  
Size: 99 Tons



L: 11' 3"  
W: 8' 6"  
H: 9' 8"



People and ideas you can trust.™

**Table 7: SWP 065 through SWP 130 Physical Data**

Data	Large Tall Cabinet											
	065	073	080	088	099	105	120	130				
<b>Compressor</b>												
Quantity	4	6				8						
Size (HP)	15	10 (4), 13 (2)	10 (2), 13 (4)	13	15	13	13 (4), 15 (4)		15			
Number of refrigeration circuits	4	6				8						
<b>Evaporator coil</b>												
Coil size	Std				Std	Lg	Std	Lg	Std	Lg	Std	Lg
Face area (ft <sup>2</sup> )	60.9				60.9	71.3	60.9	71.3	60.9	71.3	60.9	71.3
Number of rows	6											
FPI	12											
<b>Performance</b>												
Total capacity <sup>1</sup> (MBH)	946	1052	1128	1202	1343	1381	1451	1527	1526	1606	1621	1701
<b>Pre-heating coil</b>												
Hot water coil face area (ft <sup>2</sup> )	69.8 or 69.1											
Available rows	1 or 2											
<b>Waterside economizer coil</b>												
Face area (ft <sup>2</sup> )	60.9			60.9	71.3	60.9	71.3	60.9	71.3	60.9	71.3	
Rows	4											
FPI	12											
Maximum working pressure (PSIG)	300 standard, 450 optional											
<b>Face loaded filters</b>												
(Quantity) Size	(20) 24×24											
2" filter options	30% (MERV7), 75% (MERV13)											
4" filter options	30% (MERV8), 75% (MERV11), 85% (MERV14)											
Pre-filter options	2"-30% with 4"-65%, 2"-30% with 4"-75%, 2"-30% with 4"-85%											
<b>Evaporator fan<sup>2</sup></b>												
Quantity	1											
Available diameter (Inches)	24, 27, 30, 33, 37, 40, 44											
Maximum motor size (HP)	50											
CAV minimum design (CFM) <sup>3</sup>	12180			12180	14260	12180	14260	12180	14260	12180	14260	
VAV minimum design (CFM) <sup>3</sup>	24360			24360	28520	24360	28520	24360	28520	24360	28520	
Maximum design (CFM) <sup>3</sup>	36540			36540	42780	36540	42780	36540	42780	36540	42780	
<b>Electric heat</b>												
Nominal output (kW)	68											
Control sequence	2-stage											
<b>Condenser</b>												
Maximum working pressure (PSIG)	300 standard, 450 optional											
Mechanical cooling minimum EWT (°F)	55											
Minimum flow rate (GPM)	158	175	188	200	224	230	242	254	254	268	270	284
Maximum flow rate (GPM)	237	263	282	300	336	345	363	382	382	402	405	425

**NOTE:**

- Based on AHRI 340/360 standard rating conditions, 80/67°F to the coil, 85/95°F condenser water.
- Standard fan TSP limit is 6.0 inches of water. Consult your local Daikin sales representative for applications beyond this range.
- Minimum design airflow calculated for CAV at 200 fpm, VAV at 400 fpm and a maximum design airflow calculated at 600 fpm.

**Table 15: SWP 065–SWP130 (Large Tall Cabinet) Cooling Capacity**

Unit	EAT DB/WB (°F)	EWT (°F)	Capacity		LAT		Flow Rate (GPM)
			Total (MBH)	Sensible (MBH)	DB (°F)	WB (°F)	
<b>SWP 065HS</b>							
(4) 15 hp Compressors 6-row Standard DX Coil 24,000 cfm R410A	75.0/62.0	75	868	682	49.0	48.9	208
		85	832	666	49.6	49.5	204
		95	794	649	50.3	50.2	200
	80.0/67.0	75	940	673	54.3	54.3	224
		85	900	657	55.0	54.9	219
		95	856	640	55.6	55.6	214
	85.0/72.0	75	1017	662	59.8	59.7	241
		85	973	646	60.4	60.3	235
		95	925	629	61.0	61.0	229
<b>SWP 073HS</b>							
(4) 10 hp, (2) 13 hp Compressors 6-row Standard DX Coil 27,500 cfm R410A	75.0/62.0	75	983	778	49.1	49.1	233
		85	941	759	49.7	49.7	229
		95	896	739	50.4	50.3	224
	80.0/67.0	75	1050	761	54.6	54.6	24.7
		85	1018	749	55.1	55.1	245
		95	969	730	55.7	55.7	240
	85.0/72.0	75	1148	754	59.9	59.9	268
		85	1099	736	60.5	60.5	262
		95	1046	717	61.2	61.1	256
<b>SWP 080HL</b>							
(2) 10 hp, (4) 13 hp Compressors 6-row Standard DX Coil 29,500 cfm R410A	75.0/62.0	75	1062	837	49.0	49.0	252
		85	1016	817	49.7	49.6	247
		95	967	795	50.4	50.3	242
	80.0/67.0	75	1151	827	54.4	54.3	271
		85	1101	806	55.0	54.9	265
		95	1047	785	55.7	55.6	259
	85.0/72.0	75	1245	813	59.8	59.8	291
		85	1190	793	60.4	60.4	284
		95	1132	773	61.1	61.0	277
<b>SWP 088HS</b>							
(6) 13 hp Compressors 6-row Standard DX Coil 31,500 cfm R410A	75.0/62.0	75	1140	897	49.0	48.9	271
		85	1091	874	49.6	49.5	265
		95	1039	851	50.3	50.2	260
	80.0/67.0	75	1238	886	54.3	54.2	292
		85	1183	864	54.9	54.9	285
		95	1126	841	55.6	55.5	279
	85.0/72.0	75	1340	872	59.7	59.7	314
		85	1280	850	60.3	60.3	306
		95	1217	828	61.0	60.9	299
<b>SWP 099HS</b>							
(6) 15 hp Compressors 6-row Large DX Coil 36,250 cfm R410A	75.0/62.0	75	1297	1024	49.2	49.0	311
		85	1244	1000	49.8	49.6	306
		95	1186	974	50.4	50.3	300
	80.0/67.0	75	1403	1010	54.5	54.4	334
		85	1346	987	55.1	55.0	328
		95	1282	961	55.8	55.6	321
	85.0/72.0	75	1514	992	60.0	59.9	358
		85	1451	969	60.6	60.5	351
		95	1382	945	61.2	61.1	343
<b>SWP 099HL</b>							
(6) 15 hp Compressors 6-row Large DX Coil 36,250 cfm R410A	75.0/62.0	75	1313	1032	49.0	48.9	314
		85	1259	1008	49.6	49.5	309
		95	1200	982	50.2	50.1	303
	80.0/67.0	75	1420	1018	54.3	54.3	338
		85	1362	994	54.9	54.8	331
		95	1297	969	55.6	55.5	324
	85.0/72.0	75	1531	999	59.8	59.8	362
		85	1468	976	60.4	60.3	355
		95	1398	952	61.0	60.9	346

**NOTE:**

See Table 17 on page 48 to determine unit capacity at other than nominal cfm.

For a computer-generated, job-specific selection, contact your local Daikin sales representative. For 50 Hz applications, derate the total capacity by 0.89; derate the sensible capacity by 0.94. All capacities are gross and do not account for fan motor heat.

Altitude and/or glycol selections are also available.

Figure 57: Self-Contained SWP—Front View (Left Hand Access Shown/Optional Plenum)

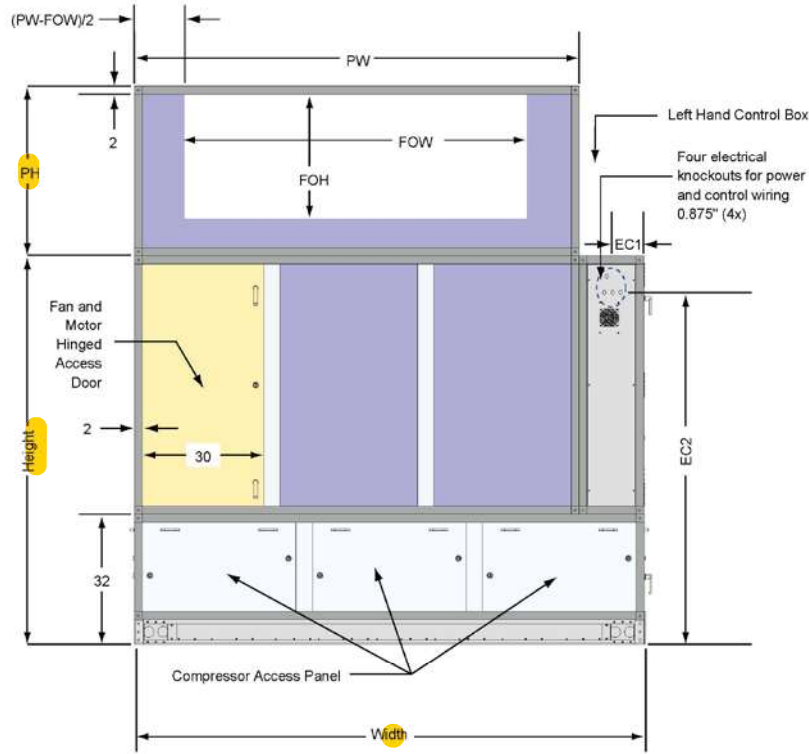

Table 28: Dimensions (Inches)

Cabinet and Unit Sizes		Small	Small Tall	Medium		Large	Large Tall	
		023-033	039-050	044-051	056-066	062-088	065-099	105-130
Total Unit	Height <sup>1, 2</sup>	80.0	84.0	96.0	96.0	96.0	112.0	112.0
	Width <sup>1, 2</sup>	84.0	84.0	102.0	102.0	126.0	126.0	126.0
	Depth <sup>1, 2</sup>	80.0	80.0	88.0	88.0	98.0	98.0	106.0
Power and Control Knockouts	EC1	5.5	5.5	7.5	7.5	7.5	7.5	7.5
	EC2	71.0	75.0	87.0	87.0	87.0	103.0	103.0
Plenum Width	PW <sup>3, 4</sup>	70.0	70.0	86.0	86.0	110.0	110.0	110.0
Plenum Depth	PD <sup>3, 4</sup>	44.0	44.0	48.0	48.0	58.0	58.0	66.0
Condenser Water Connections (ODS)	WC1	23.0	23.0	25.0	25.0	27.0	27.0	27.0
	WC3	74.0	78.0	90.0	90.0	90.0	106.0	106.0
	DIA1	2.125	2.625	2.625	3.125	3.125	3.125	4.125
	DIA2	2.125	2.625	2.625	3.125	3.125	3.125	4.125
Drain Connections (MPT)	DC1	18.0	18.0	20.0	20.0	20.0	20.0	20.0
	DC2	7.0	7.0	7.0	7.0	9.0	9.0	9.0
Fan Discharge Opening	DOD	32.0	32.0	32.0	32.0	32.0	40.0	40.0
	DOL	10.0	10.0	10.0	10.0	10.0	10.0	10.0
	DOW	52.0	52.0	68.0	68.0	92.0	92.0	92.0
Fan and Compressor Section Depth	SD1	44.0	44.0	48.0	48.0	58.0	58.0	66.0
Coil Section Depth	SD2	36.0	36.0	40.0	40.0	40.0	40.0	40.0
Control Panel Width	SW1	14.0	14.0	16.0	16.0	16.0	16.0	16.0

NOTE:

- Dimensions do not include lifting lugs, handles, latches or fastener extensions.
- For shipping dimensions, add 4" to the depth, 8" to the length and 4" to the height.
- Plenum height is user configurable.
- Plenum opening height and width requires a minimum of 2" clearance on each side.

Figure 58: Self-Contained SWP Left Side View (Left Hand Access Shown with Piping and Optional Discharge Plenum)

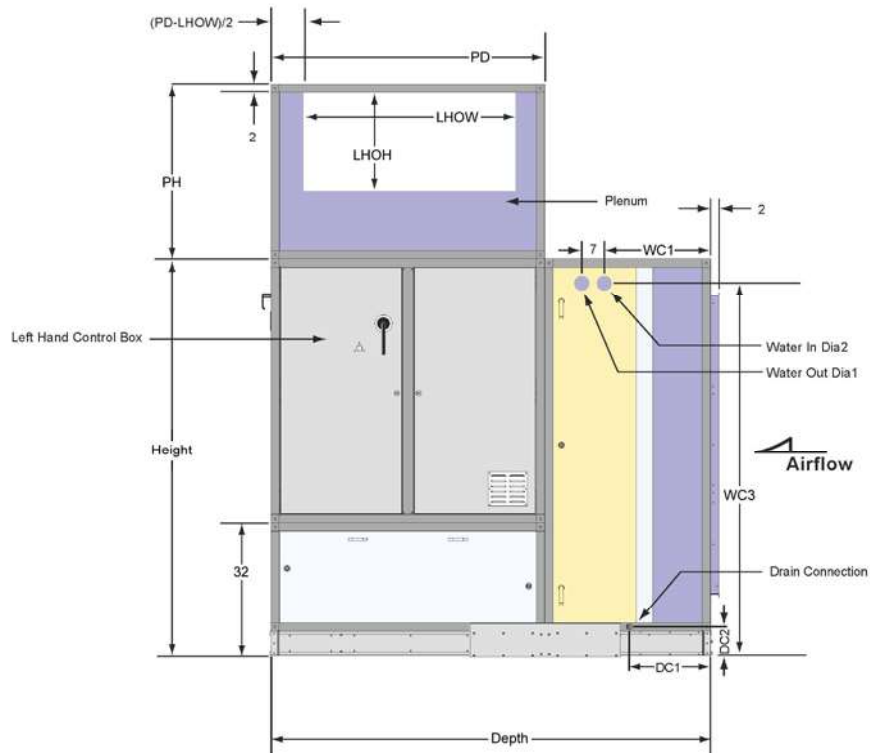

Figure 59: Self-Contained Top View (Left Hand Access Shown/without Discharge Plenum)

