

# Series 1500 Cooling Towers

# Engineering Data

Model #: 15310

Serial #: U107117101

2010

310 Ton



## Engineering Data

|                                       |   |
|---------------------------------------|---|
| Single/Multi-Cell Units .....         | 1 |
| Dimensional Reference Drawings .....  | 2 |
| Structural Support .....              | 3 |
| Structural Support Alternatives ..... | 4 |

Operating Weight: 17,050 lbs  
Shipping Weight: 7,070 lbs

# Engineering Data

## Single Cell Unit

Series 1500 Engineering Data

| Model Number | Nominal Tonnage <sup>a</sup> | Motor HP | Ind. Fan Motor Option | Fan (CFM) | Weights (lbs)          |          |                  | Dimensions |            |           |            |           | Inlet Conn. <sup>2</sup> |  |
|--------------|------------------------------|----------|-----------------------|-----------|------------------------|----------|------------------|------------|------------|-----------|------------|-----------|--------------------------|--|
|              |                              |          |                       |           | Operating <sup>1</sup> | Shipping | Heaviest Section | L          | H          | A         | C          | D         |                          |  |
| 15146        | 146                          | 7.5      | N/A                   | 40,320    | 7,920                  | 3,940    | 3,940            |            |            |           |            |           |                          |  |
| 15160        | 160                          | 10       | N/A                   | 44,190    | 7,940                  | 3,960    | 3,960            | 8' 5-3/4"  | 10' 2-7/8" | N/A       | 9' 8-5/8"  | 4' 2-7/8" | 6"                       |  |
| 15176        | 176                          | 15       | N/A                   | 48,160    | 7,990                  | 4,010    | 4,010            |            |            |           |            |           |                          |  |
| 15162        | 162                          | 7.5      | N/A                   | 43,080    | 8,610                  | 4,200    | 4,200            |            |            |           |            |           |                          |  |
| 15177        | 177                          | 10       | N/A                   | 47,070    | 8,630                  | 4,220    | 4,220            | 8' 5-3/4"  | 11' 6-7/8" | N/A       | 11' 0-5/8" | 4' 2-7/8" | 6"                       |  |
| 15201        | 201                          | 15       | N/A                   | 53,540    | 8,690                  | 4,280    | 4,280            |            |            |           |            |           |                          |  |
| 15219        | 219                          | 20       | N/A                   | 58,240    | 8,710                  | 4,300    | 4,300            |            |            |           |            |           |                          |  |
| 15200        | 200                          | 10       | N/A                   | 52,320    | 11,430                 | 5,350    | 2,770            |            |            |           |            |           |                          |  |
| 15227        | 227                          | 15       | N/A                   | 59,380    | 11,490                 | 5,410    | 2,780            | 8' 5-3/4"  | 14' 3-3/8" | 7' 4-3/4" | 13' 9-1/4" | 4' 2-7/8" | 6"                       |  |
| 15250        | 250                          | 20       | N/A                   | 65,400    | 11,510                 | 5,430    | 2,800            |            |            |           |            |           |                          |  |
| 15214        | 214                          | 10       | N/A                   | 56,610    | 12,450                 | 5,640    | 2,920            |            |            |           |            |           |                          |  |
| 15245        | 245                          | 15       | N/A                   | 64,810    | 12,510                 | 5,700    | 2,920            | 8' 5-3/4"  | 15' 7-3/8" | 8' 8-3/4" | 15' 1-1/4" | 4' 2-7/8" | 6"                       |  |
| 15270        | 270                          | 20       | N/A                   | 71,420    | 12,530                 | 5,720    | 2,920            |            |            |           |            |           |                          |  |
| 15282        | 282                          | 25       | N/A                   | 74,600    | 12,610                 | 5,800    | 2,920            |            |            |           |            |           |                          |  |
| 15296        | 296                          | 15       | (2) 7.5               | 77,440    | 15,540                 | 6,750    | 3,540            |            |            |           |            |           |                          |  |
| 15325        | 325                          | 20       | (2) 10                | 85,030    | 15,590                 | 6,800    | 3,590            | 12' 1-1/4" | 14' 3-3/8" | 7' 4-3/4" | 13' 9-1/4" | 6' 0-5/8" | 8"                       |  |
| 15350        | 350                          | 25       | (2) 15                | 91,560    | 15,640                 | 6,850    | 3,640            |            |            |           |            |           |                          |  |
| 15368        | 368                          | 30       | (2) 15                | 96,280    | 15,660                 | 6,870    | 3,660            |            |            |           |            |           |                          |  |
| 15310        | 310                          | 15       | (2) 7.5               | 82,000    | 17,050                 | 7,070    | 3,540            |            |            |           |            |           |                          |  |
| 15340        | 340                          | 20       | (2) 10                | 89,940    | 17,100                 | 7,120    | 3,590            |            |            |           |            |           |                          |  |
| 15365        | 365                          | 25       | (2) 15                | 96,550    | 17,150                 | 7,170    | 3,640            | 12' 1-1/4" | 15' 7-3/8" | 8' 8-3/4" | 15' 1-1/4" | 6' 0-5/8" | 8"                       |  |
| 15385        | 387                          | 30       | (2) 15                | 101,840   | 17,180                 | 7,200    | 3,670            |            |            |           |            |           |                          |  |
| 15425        | 428                          | 40       | (2) 20                | 112,340   | 17,450                 | 7,470    | 3,940            |            |            |           |            |           |                          |  |

## Multi-Cell Units

|         |     |         |         |         |        |        |       |        |            |           |            |           |        |  |
|---------|-----|---------|---------|---------|--------|--------|-------|--------|------------|-----------|------------|-----------|--------|--|
| 15146-2 | 292 | (2) 7.5 | N/A     | 80,640  | 15,840 | 7,880  | 3,940 |        |            |           |            |           |        |  |
| 15160-2 | 320 | (2) 10  | N/A     | 88,380  | 15,880 | 7,920  | 3,960 | 17' 2" | 10' 2-7/8" | N/A       | 9' 8-5/8"  | 4' 2-7/8" | (2) 6" |  |
| 15176-2 | 352 | (2) 15  | N/A     | 96,320  | 15,890 | 8,020  | 4,010 |        |            |           |            |           |        |  |
| 15162-2 | 324 | (2) 7.5 | N/A     | 86,160  | 17,220 | 8,400  | 4,200 |        |            |           |            |           |        |  |
| 15177-2 | 354 | (2) 10  | N/A     | 94,140  | 17,260 | 8,440  | 4,220 | 17' 2" | 11' 6-7/8" | N/A       | 11' 0-5/8" | 4' 2-7/8" | (2) 6" |  |
| 15201-2 | 402 | (2) 15  | N/A     | 106,900 | 17,380 | 8,560  | 4,280 |        |            |           |            |           |        |  |
| 15219-2 | 438 | (2) 20  | N/A     | 116,480 | 17,420 | 8,600  | 4,300 |        |            |           |            |           |        |  |
| 15200-2 | 400 | (2) 10  | N/A     | 104,640 | 22,860 | 10,700 | 2,770 |        |            |           |            |           |        |  |
| 15227-2 | 454 | (2) 15  | N/A     | 118,760 | 22,980 | 10,820 | 2,780 | 17' 2" | 14' 3-3/8" | 7' 4-3/4" | 13' 9-1/4" | 4' 2-7/8" | (2) 6" |  |
| 15250-2 | 500 | (2) 20  | N/A     | 130,800 | 23,020 | 10,860 | 2,800 |        |            |           |            |           |        |  |
| 15214-2 | 428 | (2) 10  | N/A     | 113,220 | 24,900 | 11,280 | 2,920 |        |            |           |            |           |        |  |
| 15245-2 | 490 | (2) 15  | N/A     | 129,620 | 25,020 | 11,400 | 2,920 | 17' 2" | 15' 7-3/8" | 8' 8-3/4" | 15' 1-1/4" | 4' 2-7/8" | (2) 6" |  |
| 15270-2 | 540 | (2) 20  | N/A     | 142,840 | 25,060 | 11,440 | 2,920 |        |            |           |            |           |        |  |
| 15282-2 | 564 | (2) 25  | N/A     | 149,200 | 25,220 | 11,600 | 2,920 |        |            |           |            |           |        |  |
| 15296-2 | 592 | (2) 15  | (4) 7.5 | 154,880 | 31,080 | 13,500 | 3,540 |        |            |           |            |           |        |  |
| 15325-2 | 650 | (2) 20  | (4) 10  | 170,060 | 31,180 | 13,600 | 3,590 | 24' 5" | 14' 3-3/8" | 7' 4-3/4" | 13' 9-1/4" | 6' 0-5/8" | (2) 8" |  |
| 15350-2 | 700 | (2) 25  | (4) 15  | 183,120 | 31,280 | 13,700 | 3,640 |        |            |           |            |           |        |  |
| 15368-2 | 736 | (2) 30  | (4) 15  | 192,560 | 31,320 | 13,740 | 3,660 |        |            |           |            |           |        |  |
| 15310-2 | 620 | (2) 15  | (4) 7.5 | 164,000 | 34,100 | 14,140 | 3,540 |        |            |           |            |           |        |  |
| 15340-2 | 680 | (2) 20  | (4) 10  | 179,880 | 34,200 | 14,240 | 3,590 |        |            |           |            |           |        |  |
| 15365-2 | 730 | (2) 25  | (4) 15  | 193,100 | 34,300 | 14,340 | 3,640 | 24' 5" | 15' 7-3/8" | 8' 8-3/4" | 15' 1-1/4" | 6' 0-5/8" | (2) 8" |  |
| 15385-2 | 774 | (2) 30  | (4) 15  | 203,680 | 34,360 | 14,400 | 3,670 |        |            |           |            |           |        |  |
| 15425-2 | 856 | (2) 40  | (4) 20  | 224,680 | 34,900 | 14,940 | 3,940 |        |            |           |            |           |        |  |

Do not use for construction. Refer to factory certified dimensions.



# Dimensional Reference Drawings

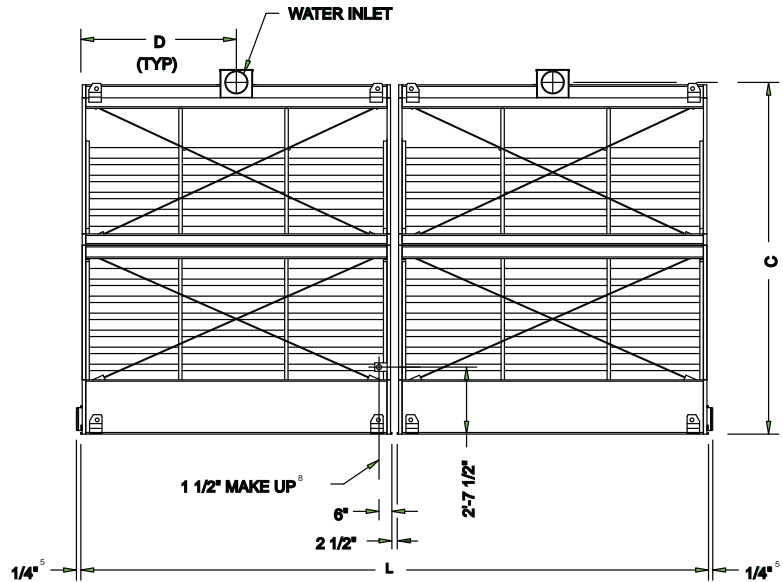
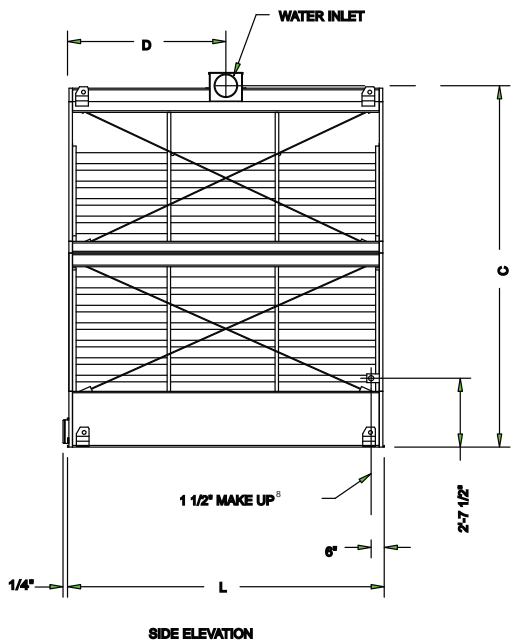
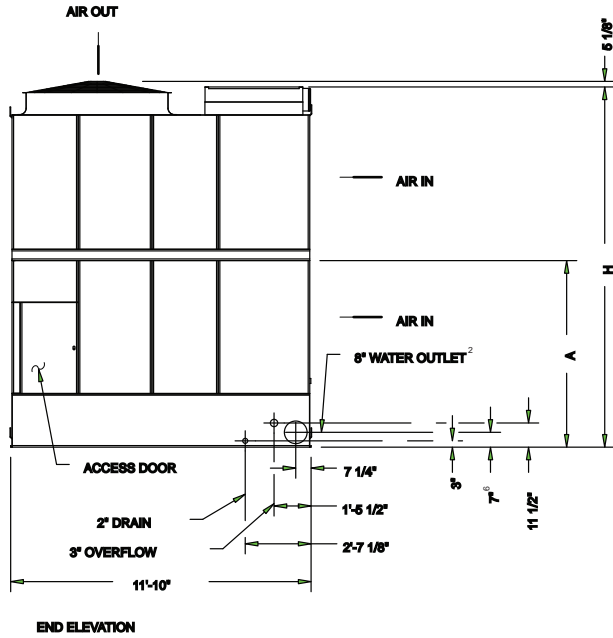

**Notes:**

1. Operating weight is for tower with water level in the cold water basin at overflow. If a lower operating weight is needed to meet design requirements, your local BAC Representative can provide additional assistance.
2. The specific size of the inlet and outlet connection may vary with the cooling water design flow rate. Consult unit print for dimensions.
3. Unless otherwise indicated, all connections 3" and smaller are MPT. Connections 4" and larger are beveled for welding and mechanically grooved.
4. The heaviest section for all models except 15214 through 15282 is the upper section. Models 15146 to 15219 ship in one piece.
5. Models 15296 through 15425 – 2 1/8"
6. Models 15296 through 15425 – 8"
7. Models 15146 through 15219 and 15296 through 15425 – 2 3/4"
8. Models 15296 through 15425 – 1 1/2"
9. Nominal tons of cooling represents 3 GPM of water cooled from 95°F to 85°F at a 78°F entering wet-bulb temperature.

