

Model #: WME0500S  
Serial #: STNU090800006

2009  
500 Tons

**DAIKIN McQUAY™**



**Magnitude™ Frictionless Centrifugal Chiller      Catalog 604**

**Model WME**

400 to 550 tons (1400 to 1900 kW)  
3/60/460  
HFC-134a



L: 14' 2"  
W: 6' 7"  
H: 8' 2"

Shipping Weight: 17,881 lbs  
Operating Weight: 20,630 lbs

*Engineered for flexibility and performance™*

# Chiller Identification

Figure 3: Magnitude Code String Chiller Identification

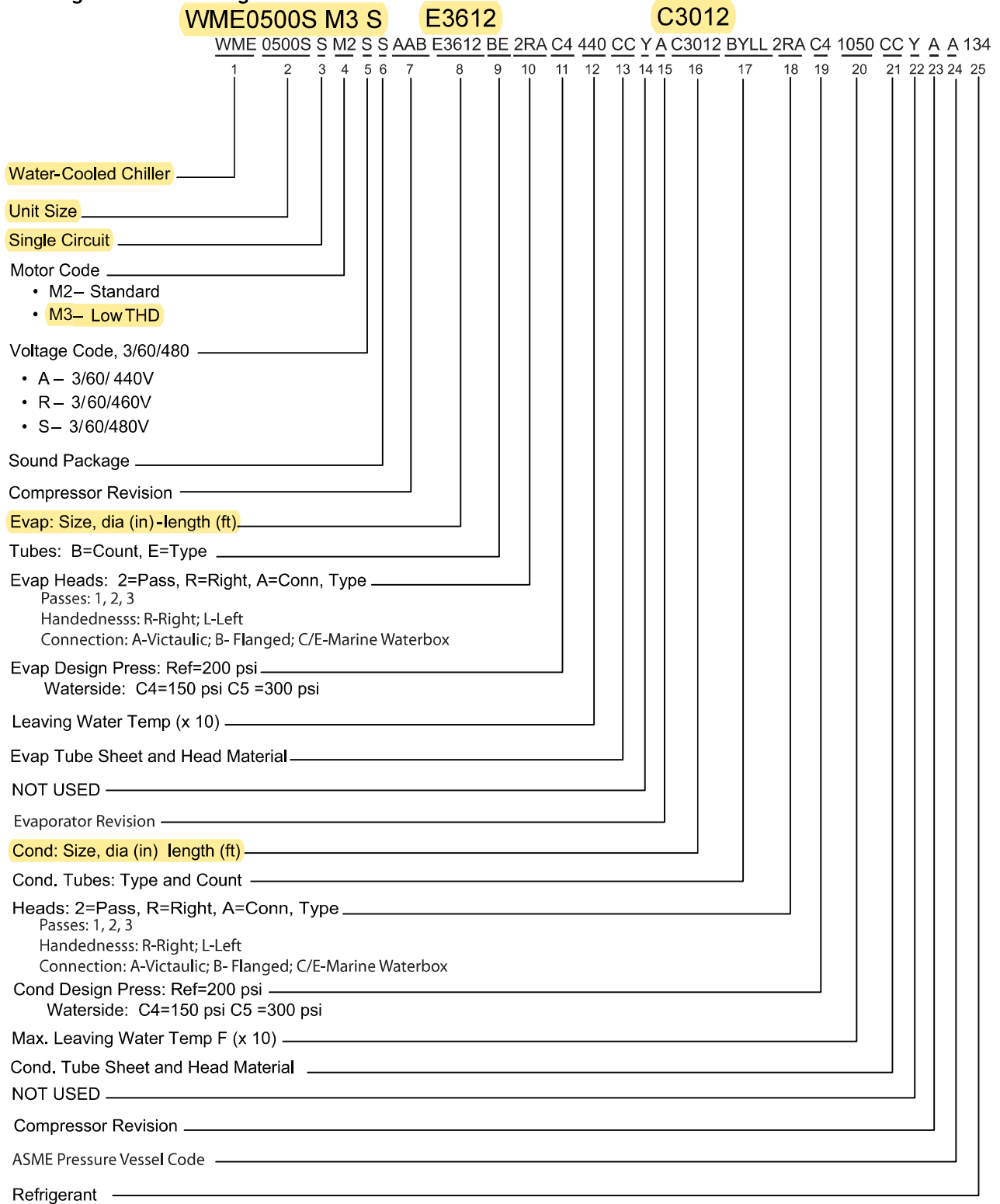

**Figure 6: Model WME500 - E3612/C3012 - 2-pass, M3 (Low THD) motor (See page 16 for drawing notes)**

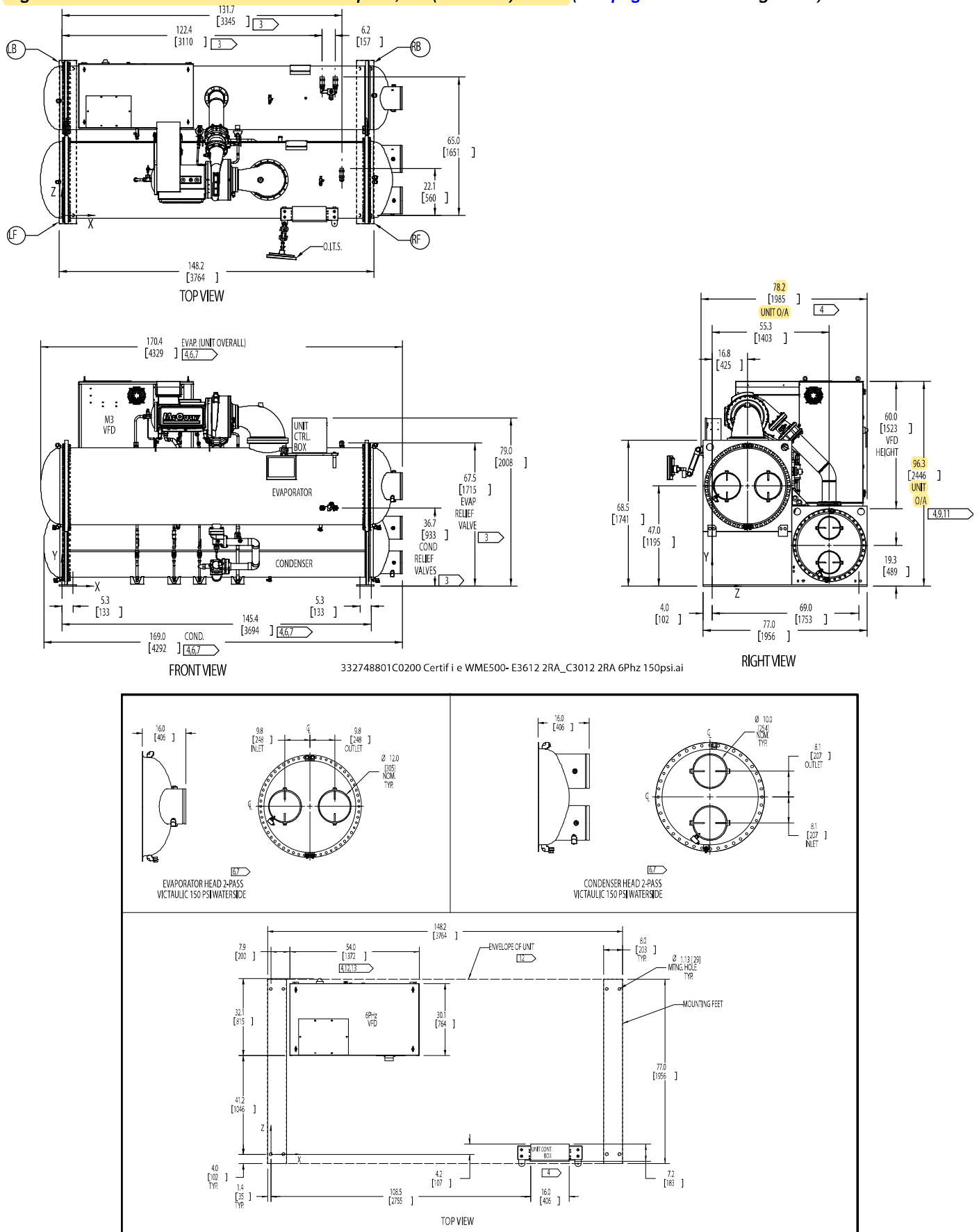

332748801C0200 Certif i e WME500- E3612 2RA\_C3012 2RA 6Phz 150psi.ai

## Lifting and Mounting Weights

Figure 11: Corner Identification

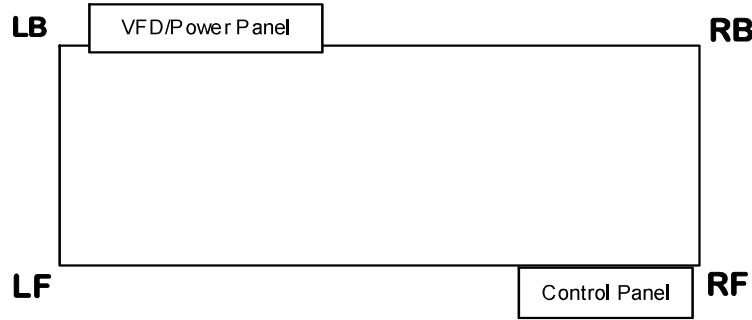

**NOTES:**

- 1 The block shown above is the mounting footprint, not the entire unit footprint.
- 2 Lifting holes in the top of the tube sheets are 3.25-inch (83 mm) diameter.
- 3 Mounting holes in the feet are 1.125-inch diameter.

**Table 4: Lifting and Mounting Weights**

WME Model	Vessel Models (Size)	Motor Code	Lifting (Shipping) Weight, lbs (kg)					Center of Gravity in. (mm)		
			LF	RF	LB	RB	Total	X	Y	Z
0500	E3612/C3012	M2	4408 (1999)	3940 (1787)	4479 (2032)	4003 (1816)	16830 (7634)	68.6 (1743)	38.0 (964)	34.8 (883)
0500	E3012/C2612	M2	3471 (1575)	2997 (1359)	3626 (1645)	3130 (1420)	13224 (5998)	67.4 (1711)	36.1 (917)	29.6 (753)
0500	E3612/C3012	M3	4660 (2114)	3886 (1763)	5090 (2309)	4245 (1925)	17881 (8110)	66.1 (1679)	39.2 (996)	36.0 (915)
0500	E3012/C2612	M3	3687 (1673)	2925 (1327)	4272 (1938)	3389 (1537)	14273 (6475)	64.3 (1634)	37.5 (952)	31.1 (791)
WME Model	Vessel Models (Size)	Motor Code	Mounting (Operating) Weight, lbs (kg)					Center of Gravity in. (mm)		
			LF	RF	LB	RB	Total	X	Y	Z
0500	E3612/C3012	M2	5164 (2342)	4742 (2151)	5044 (2288)	4632 (2101)	19580 (8882)	69.6 (1768)	37.2 (946)	34.1 (866)
0500	E3012/C2612	M2	3959 (1796)	3520 (1597)	4001 (1815)	3556 (1613)	15036 (6820)	68.4 (1738)	35.4 (898)	29.2 (740)
0500	E3612/C3012	M3	5421 (2459)	4682 (2124)	5649 (2562)	4879 (2213)	20630 (9358)	67.4 (1712)	38.3 (974)	35.2 (894)
0500	E3012/C2612	M3	4181 (1897)	3443 (1562)	4641 (2105)	3821 (1733)	18086 (7297)	65.7 (1668)	36.7 (931)	30.5 (775)

Figure 12: Lifting Points - See Installation Manual IM 1033 for handling information.

